

LEGEND

- ① EMPIRE AVENUE & PEARSON STREET ENTRANCES TO BE RETAINED
- ② ELECTRICITY TRANSMISSION LINES TO BE UNDERGROUNDED ALONG CROMARTY ROAD
- ③ PROPOSED LAND EXCHANGE WITH CHURCHLANDS PRIMARY SCHOOL TO RATIONALISE BOUNDARIES
- ④ LEFT-IN LEFT-OUT ACCESS ONLY
- ⑤ POSSIBLE FUTURE LINK TO STEPHENSON AVENUE (IF DOWNGRADED TO A 2 LANE BOULEVARD)
- D DRAINAGE
- PRIMARY REGIONAL ROADS RESERVATION - STEPHENSON AVENUE
- SPECIAL DESIGN & FENCING REQUIREMENTS TO ENSURE DWELLINGS ADDRESS POS & PUBLIC SPACES
- EXISTING TREES TO BE RETAINED WHERE POSSIBLE
- C POSSIBLE COMMUNITY CHILD CARE CENTRE SITE (BUT NOT LIMITED TO THESE SITES)
- CC POSSIBLE LOCATION IN EXISTING BUILDING (IF BUILDING RETAINED)
- POSSIBLE RETIREMENT VILLAGE SITE(S)
- BIN PADS
- APPLICATION AREA

R CODES

- R20 (35%)
- R30 (35%)
- R40 (20%)
- R60 (5%)
- R80 (5%)

PERCENTAGE AS REQUIRED UNDER AMENDMENT 432

Traffic management device required subject to discussion with Town of Cambridge and City of Stirling

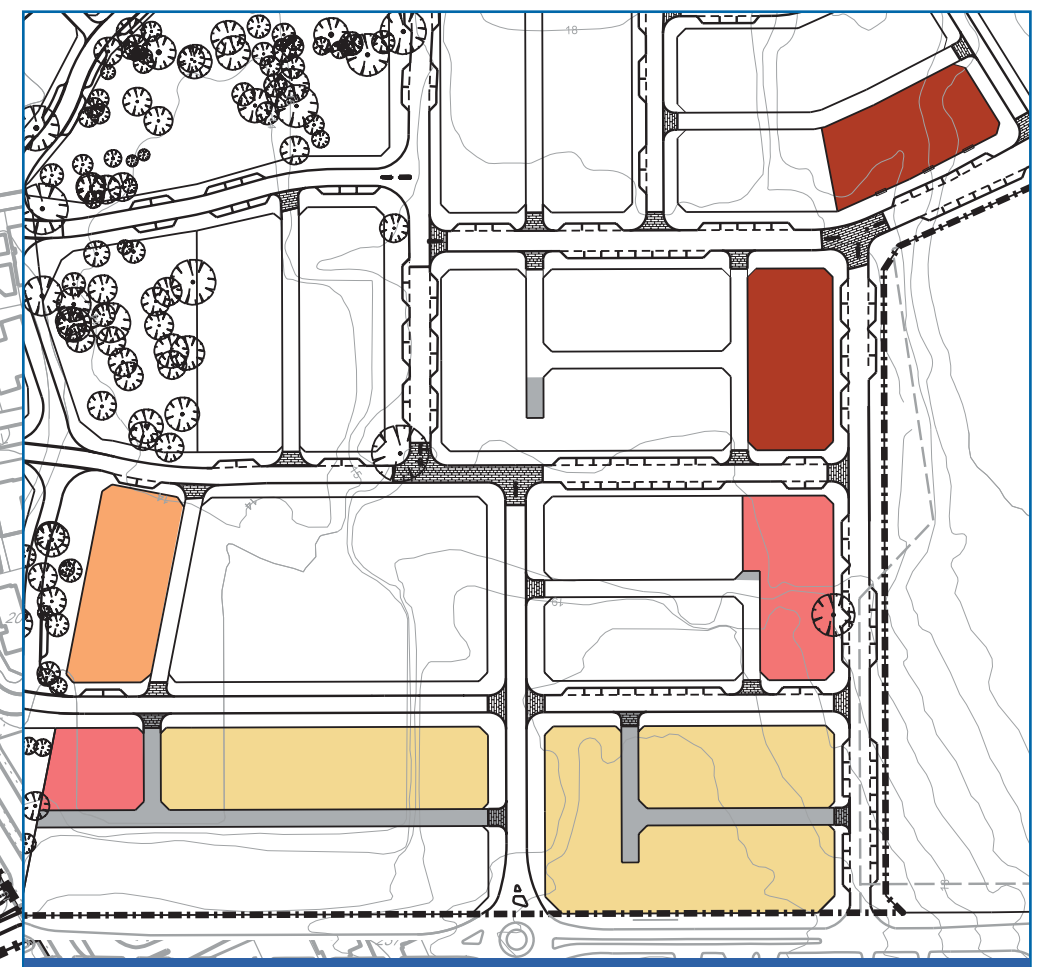
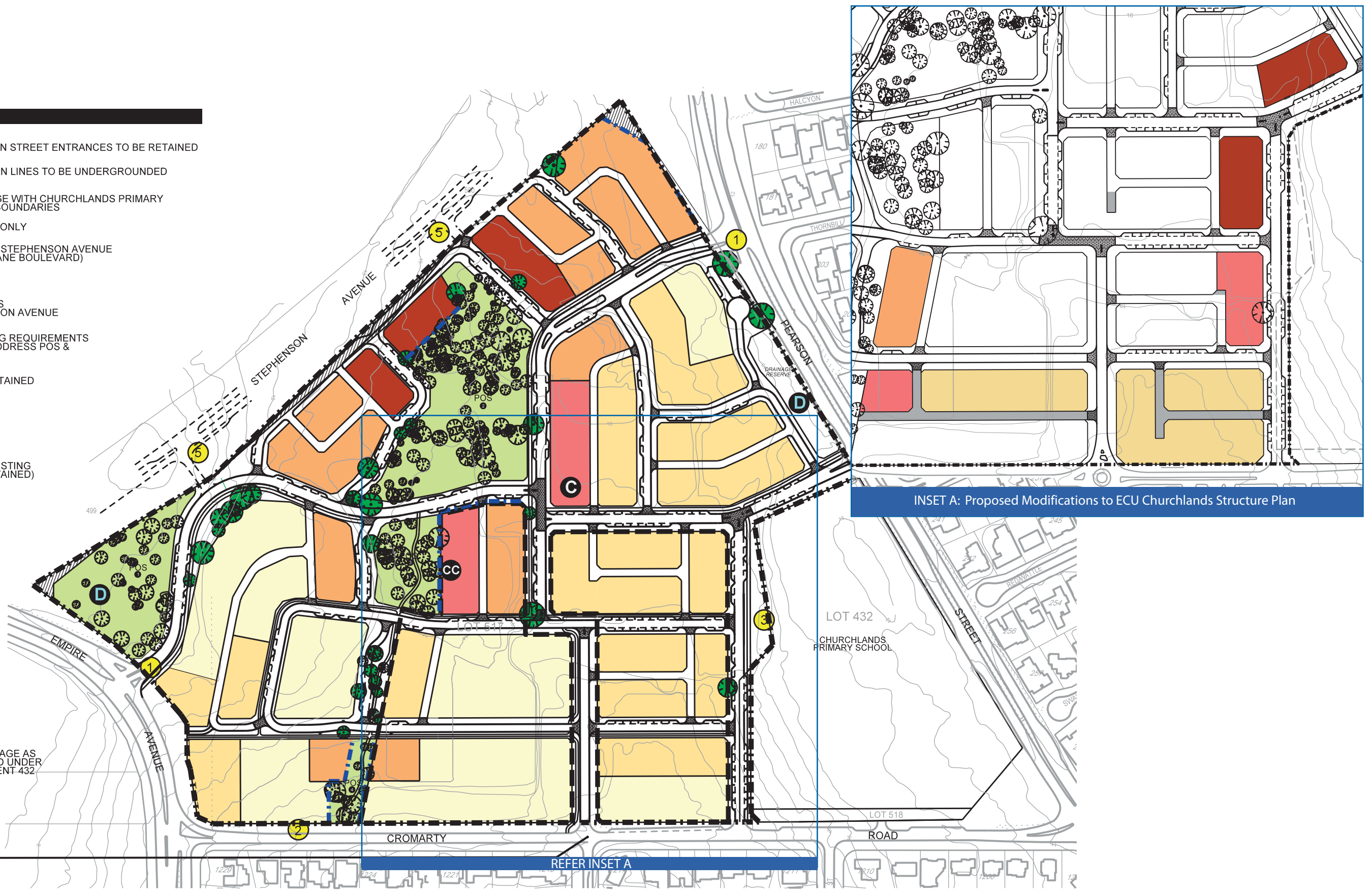

INSET A: Proposed Modifications to ECU Churchlands Structure Plan

REFER INSET A

PROPOSED MODIFICATION TO ECU CHURCHLANDS STRUCTURE PLAN
 Churchlands Green, Churchlands
 An Edith Cowan University Project

0m 25 50m
 s: NTS@A3
 d: May 2010
 j: 02/017/G002

Copyright Taylor Bunell Barnett. All rights reserved. No part of this document may be reproduced in any form or by any other means, electronic, mechanical, photocopying, microcopying or recording without permission in writing from Taylor Bunell Barnett. All areas and dimensions displayed are subject to detail survey.